

# KFVM series

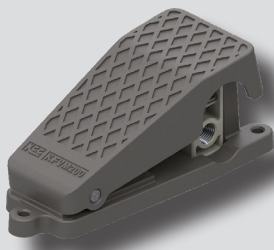

KFVM 230-02



KFVM 250-02



KFVM 250-03

공압  
슬레노이드  
밸브

KACV

KVM100

KVM200

KVMS230

KVM210

KVM341

KVM350

K

K31

K41

KHP320

KHP342

KHV320

KHV330

KHV

KFVM

KQE2000

KSQE

KPBV

KPBT

슬레노이드  
참고자료

STC

## 형식기호

KFVM    2 3 0 - 02

①                      ②                      ③

### ① 관접속형식

무기호	Rc(PT) (표준)
G	G

### ② 포트수

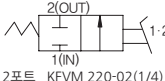
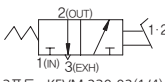
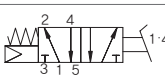
2	 2포트 KFVM 220-02(1/4)
3	 3포트 KFVM 230-02(1/4)
5	 5포트 KFVM 250-02(1/4) KFVM 250-03(3/8)

### ③ 관접속구경

02	1/4
03	3/8

※ 03(3/8)은 250(5포트)에만 적용됩니다.

## 사양

항목	KFVM220-02 230-02	KFVM250-02	KFVM250-03
사용유체	공기		
관접속구경	Rc(PT) 1/4		Rc(PT) 3/8
유효단면적 S <sub>ml</sub> (Cv)	19mm <sup>2</sup> (1.0)		45mm <sup>2</sup> (2.4)
사용압력	0.15~0.9 MPa		
주위온도 및 사용유체온도	5℃ ~ 60℃		
급유	무급유 (단, 급유시 터빈유 ISO VG32 또는 상당품)		
중량	428g	345g	542g

## 푸트 밸브 조작각도

P.T.°	8.4°
O.T.°	1.1°
T.T.°	9.5°

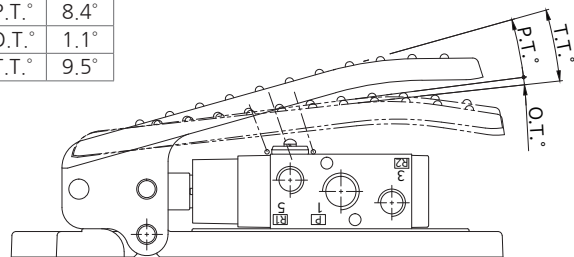

KFVM250-02

P.T.°	1.9°
O.T.°	1.6°
T.T.°	3.5°

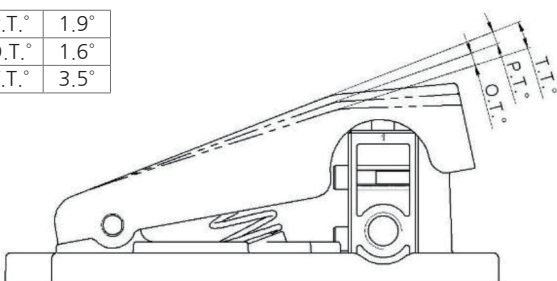

KFVM220-02  
KFVM230-02

P.T.°	7.8°
O.T.°	0.7°
T.T.°	8.5°

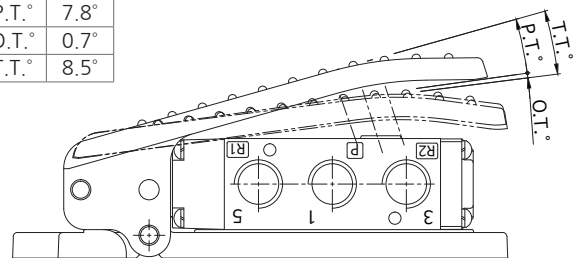

KFVM250-03

P.T.: 액츄에이터의 자유위치에서 동작위치까지의 이동거리  
O.T.: 액츄에이터의 동작위치에서 동작한도까지의 이동거리  
T.T.: 액츄에이터의 자유위치에서 동작한도까지의 이동거리

외형치수도

KFVM220-02

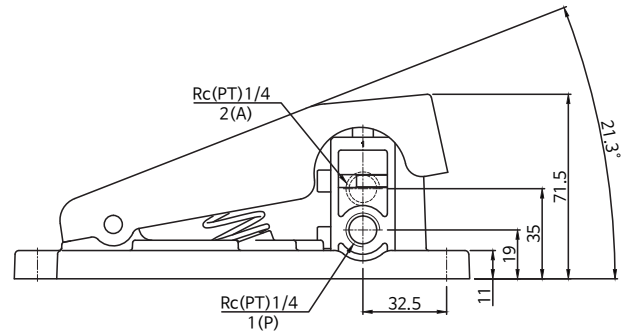
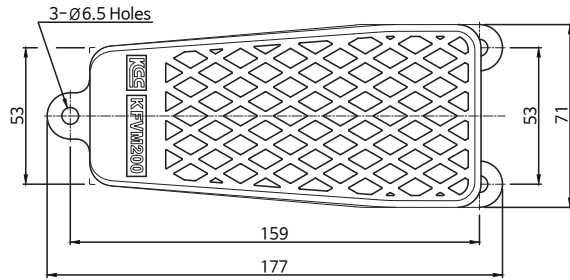

KFVM230-02

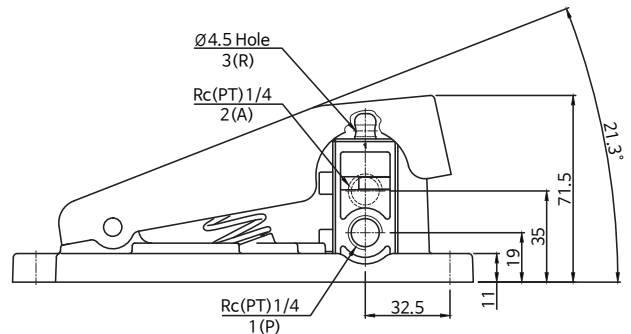
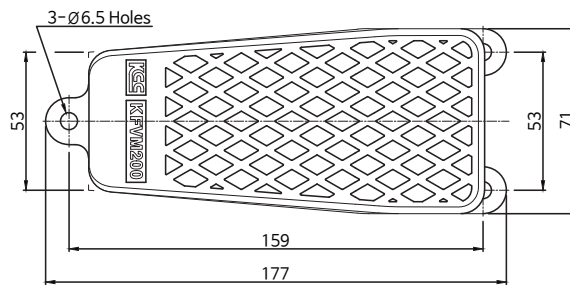

KFVM250-02, 03

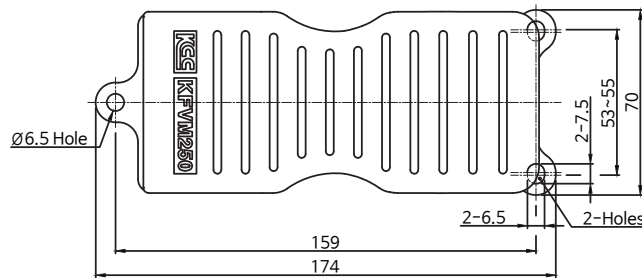

KFVM250-02

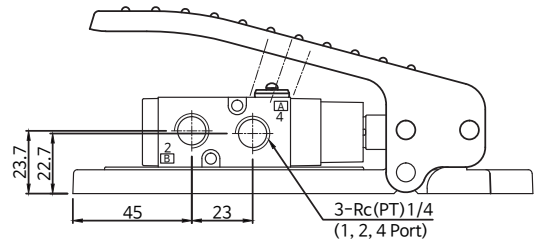
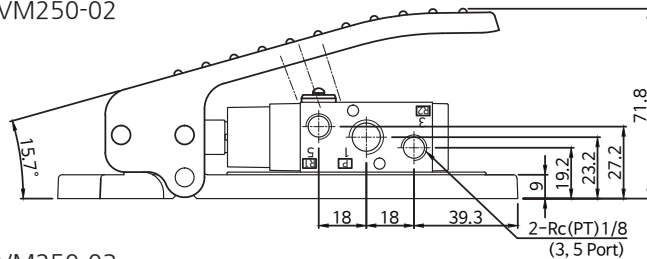

KFVM250-03

